

COUNTY OF AMADOR

T.6 N., R.10 E., M.D.M.

SECTION 1

DIST	COUNTY	ROUTE	POST MILES TOTAL PROJECT	SHEET NO.	TOTAL SHEETS
10	AMA	49	KP R11.3/R17.7 PM R7.0/R11.0	18	29

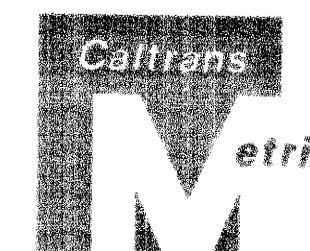

LEGEND

- FOUND MONUMENT AS DESCRIBED HEREON
- CALCULATED POINT, NOTHING FOUND OR SET
- SET MONUMENT AS DESCRIBED HEREON
- SET 1" I.D. IRON PIPE 30" LONG WITH "CALIF DOT" PLUG UNLESS OTHERWISE NOTED
- ⊥ ACCESS TO EXPRESSWAY PROHIBITED
- SUB SUBDIVISION MAPS
- M MAPS AND PLATS
- 1XXXX CALTRANS PARCEL NUMBER
- S.N.F. SEARCHED NOT FOUND
- A.C.R. AMADOR COUNTY RECORDS
- [R-] ACCORDING TO THAT CERTAIN REFERENCE MAP (SEE REFERENCE LIST)

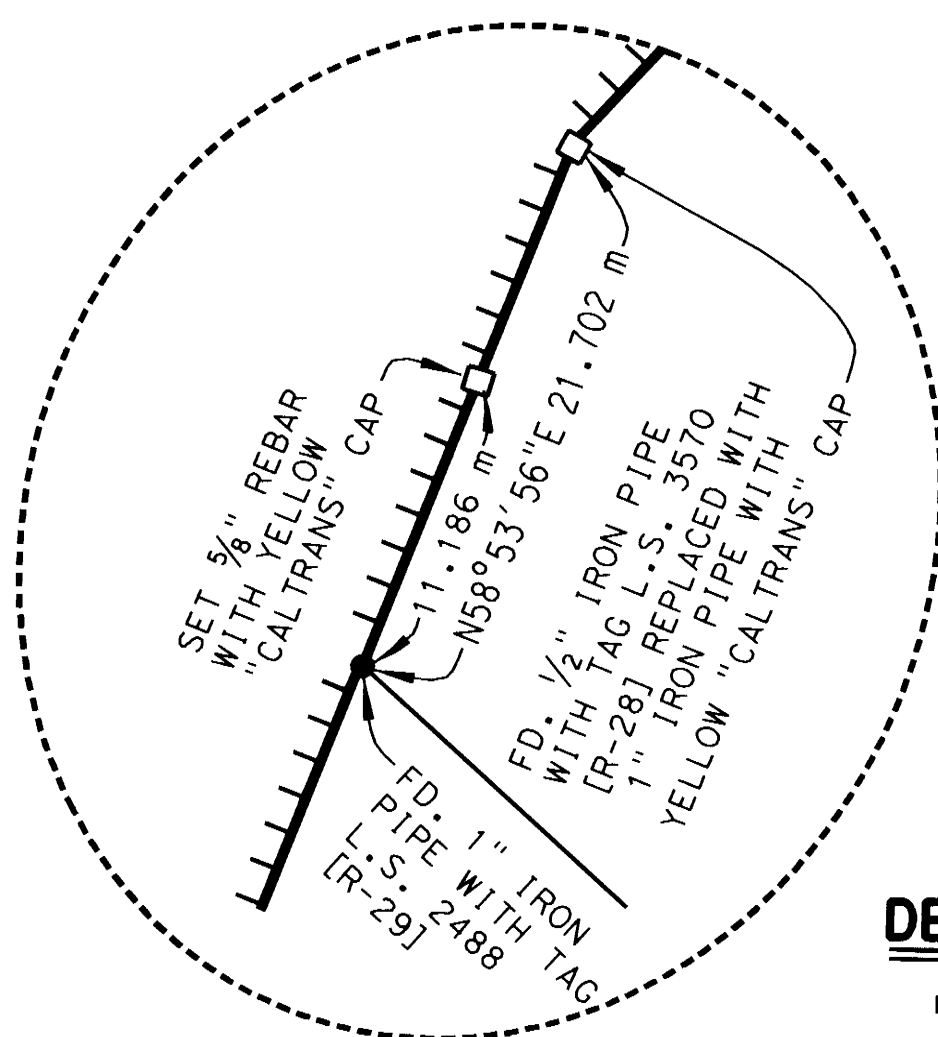

DETAIL "C"

SEE SHEET 11
NOT TO SCALE

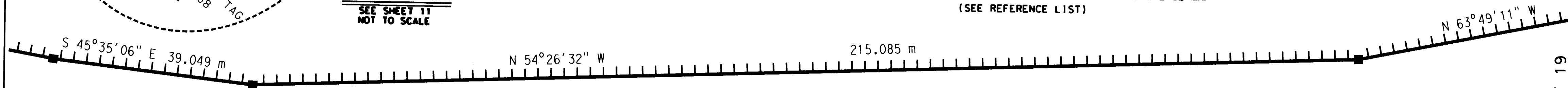

15025

CONST

SEE SHEET 17

SEE SHEET 19

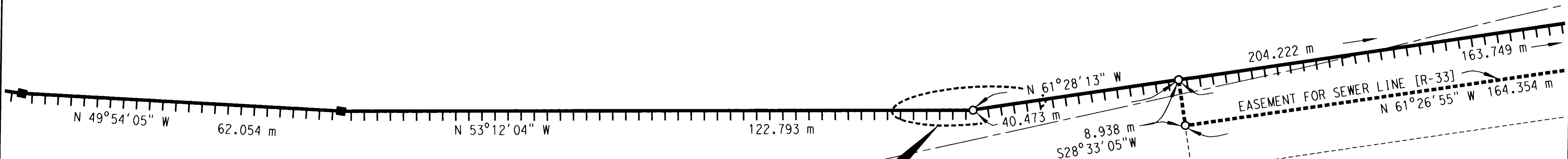

SEE DETAIL

TEMPORARY CONSTRUCTION EASEMENT
[R-33] EXPIRED DECEMBER 1, 2003

STATE OF CALIFORNIA
BUSINESS AND TRANSPORTATION AGENCY
DEPARTMENT OF TRANSPORTATION
DISTRICT 10, STOCKTON

RECORD OF SURVEY

SITUATED IN SECTIONS 1 AND 12,
T.6 N., R.10 E., SECTIONS 6, 7
AND 18, T.6 N., R.11 E., AND IN
SECTIONS 35 AND 36, T.7 N.,
R.10 E., M.D.B. & M.,
AMADOR COUNTY, CALIFORNIA
APRIL, 2008

REFERENCE LIST		
REFERENCE NUMBER	RECORDING DATA	CALTRANS NUMBER
[R-19]	GRANT DEED, DOC. NO. 2003-0005135, A.C.R.	15025
[R-28]	RECORD OF SURVEY, BOOK 31, M, PAGE 89, A.C.R.	
[R-29]	PARCEL MAP, BOOK 34, M, PAGES 18 & 19, A.C.R.	
[R-33]	GRANT DEED, DOC. NO. 2003-0005136, A.C.R.	

NOTE
ALL MEASURED DISTANCES ARE IN METERS.
TO CONVERT METERS TO THE U.S. SURVEY FOOT
MULTIPLY DISTANCES BY 3937/1200.