

FOUND IRON POST AT BASE OF
WOOD POST WITH APPROPRIATE
BEAR TREES PER 3-M-47

SALYER
638 OR 279

SIMMONS
594 OR 919

McCAULEY
583 OR 485

DAVIS
377 OR 379
0.50 ACRES

R=684.80
Δ=10°33'26"
L=126.18
CORD=126.00

PIONEER CREEK

559.13
559.13
[N02°59'E 667.6]

215.41
B.O.B.

RECORD LOCATION
E 1/16 OF SEC. 29

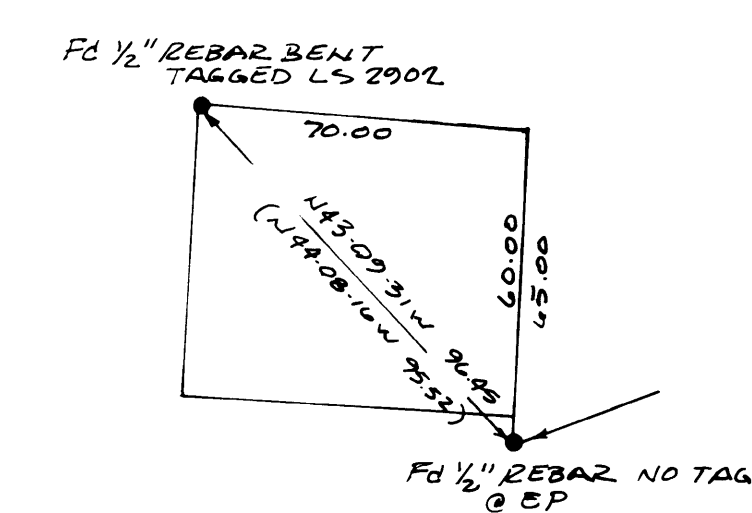

(N 30°40'13"E 330.11)
(N 38°58'29"E 330.13)

Record of Survey

FOR FRED DAVIS
377 OR 379

OF
A PORTION OF THE EAST 1/2 OF
THE SOUTHWEST 1/4 OF THE NORTH
WEST 1/4 OF SECTION 29, T.7N., R.13E.,
M.D.M.

SURVEYOR'S STATEMENT

THIS MAP CORRECTLY REPRESENTS A SURVEY
MADE BY ME OR UNDER MY CLOSE PERSONAL
SUPERVISION AND IN ACCORDANCE WITH THE REQUIREMENTS
OF THE LAND SURVEYORS ACT AT THE
REQUEST OF FRED DAVIS.

Thomas L. Jeffries
THOMAS L. JEFFRIES L.S. 4222



COUNTY SURVEYOR'S STATEMENT

THIS MAP HAS BEEN EXAMINED IN ACCORDANCE
WITH SECTION 8164 OF THE LAND SURVEYORS
ACT THIS 31 DAY OF July 1991.

C. Lee De Lange
C. LEE DE LANGE L.S. 4066
AMADOR COUNTY DEPUTY SURVEYOR
LIC. EXP. 6-30-92

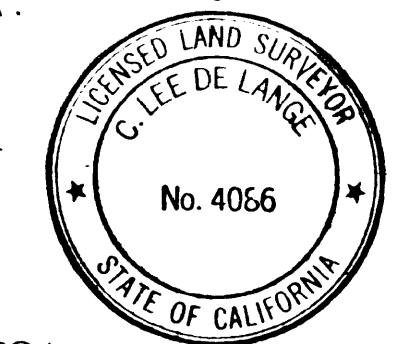

RECORDER'S STATEMENT

FILED THIS 6th DAY OF August 1991
AT 11:50 A.M. IN BOOK 45 OF MAPS AND
PLATS AT PAGE 79 AT THE REQUEST
OF THE AMADOR COUNTY DEPUTY SURVEYOR.
\$ 7.00

Sheldon D. Johnson
SHELDON D. JOHNSON
AMADOR COUNTY RECORDER

BY: Dymette R. Galdin
DEPUTY

PREPARED FOR: FRED DAVIS July 1991

PREPARED BY: JEFFRIES & ASSOCIATES
SAN ANDREAS

NOTES & LEGEND

THE BEARINGS OF THIS SURVEY ARE BASED
ON THE EAST LINE OF THE S.W. 1/4 OF
THE N.W. 1/4 OF SECTION 29, T.7N., R.13E.,
M.D.M. AS SHOWN IN BOOK 3 OF MAPS
AND PLATS ON PAGE 29 AND BOOK 45 OF MAPS
AND PLATS ON PAGE 36 BEING N02°59'E

- FD 1/2" REBAR TAGGED LS 2902 OR AS NOTED PER 6-M-36
- FOUND 1 1/4" O.D. STEEL PIPE PER 377 OR 379
- SET 5/8 REBAR TAGGED L.S. 4222, SET ON THIS SURVEY
- SET RAILROAD SPIKE, STAMPED L.S. 4222, SET ON THIS SURVEY
- () DATA PER 6-M-36
- (()) DATA PER 377 OR 379
- [] DATA PER 3-M-47