

County Surveyor's Office
Stanislaus County, Cal.

Swamp and Overflowed Lands.

Survey No 183.

Township 3 South

Range 7 East.

Section 3+10.

Fractional $E\frac{1}{2}$ of Section 10.

" $S.E.\frac{1}{4}$ " " 3.

Base and Meridian of Mt Diablo.

Containing 46.32 Acres.

Surveyed November 12th 1862.

For Martin Leahill.

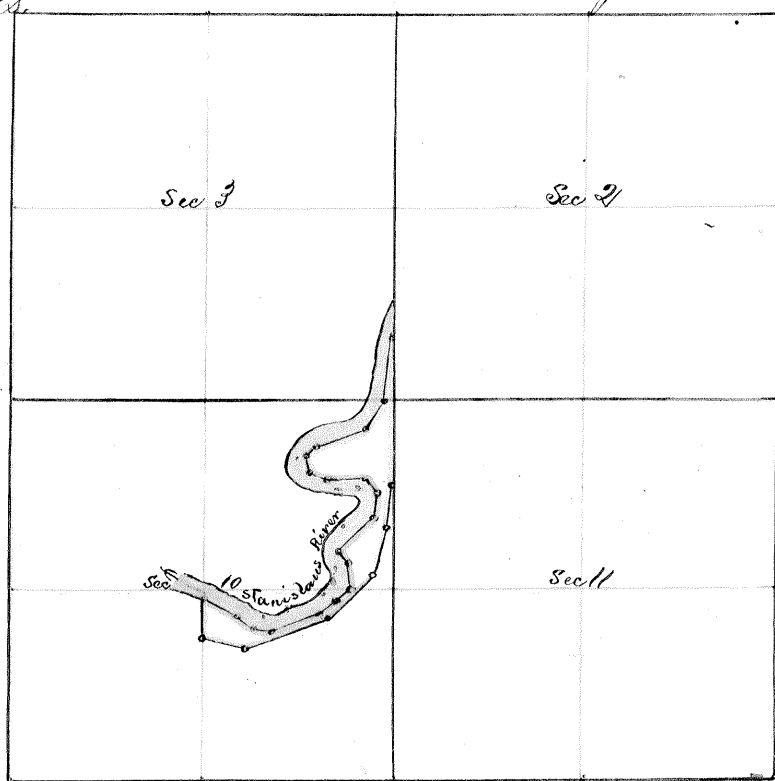

Field Notes.

Beginning at a post and mound set at intersection of the N & S line between sections 2 & 3. Township 3, south range, 7 east. with left bank of Stanislaus river, thence south 17.56 chains to a post and mound at the corner of sections 2, 3, 10 & 11. thence south 19.20 chains along U.S. meander line $S 3\frac{3}{4} W 8$ ch, $S 19 W 10$ ch, $S 49\frac{1}{2} W 14$ ch, $S 72\frac{1}{4} W 8$ ch, $N 75\frac{1}{2} W 8.70$ chains to a post and mound set at intersection with the North and South $\frac{1}{4}$ sec. line in sec 10, thence north 8.33 ch to the left bank of Stanislaus river, thence meander up stream $S 63\frac{3}{4} E 9$ ch, $S 37 E 4$ ch, $S 60\frac{1}{2} E 2$ ch, $N 72\frac{1}{4} E 12$ ch, $N 52 E 10$ ch, $N 16 W 10$ ch, $N 56 E 10$ ch, $N 8 E 4.50$ ch, $N 27\frac{1}{2} W 3.50$ ch, $S 84\frac{1}{2} W 12$ ch, $N 54 W 4$ ch, $N 5\frac{1}{2} W 2.50$ ch, $N 32\frac{1}{4} E 3.50$ ch, $N 76\frac{1}{4} E 11$ ch, $N 32\frac{1}{4} E 8$ ch, $N 8 E 18.04$ chains to point of beginning.

Run by the true Meridian; Magnetic Variation $15^{\circ} 45'$ East.

Surveyed in accordance with the Act of the Legislature concerning Swamp and Overflowed Lands, approved April 18th 1859. and the instruction of the Surveyor General.

E. B. Beard

C. Surveyor Stanislaus Co

By A. J. Stakes

Deputy

Survey approved May 4th 1863

Approval Recorded " 17. "