

OUTSIDE CORNER DETAIL

Scale= 3" = 1'-0"

SERVICE COUNTER ISOMETRIC

Scale= 3/4" = 1'-0"

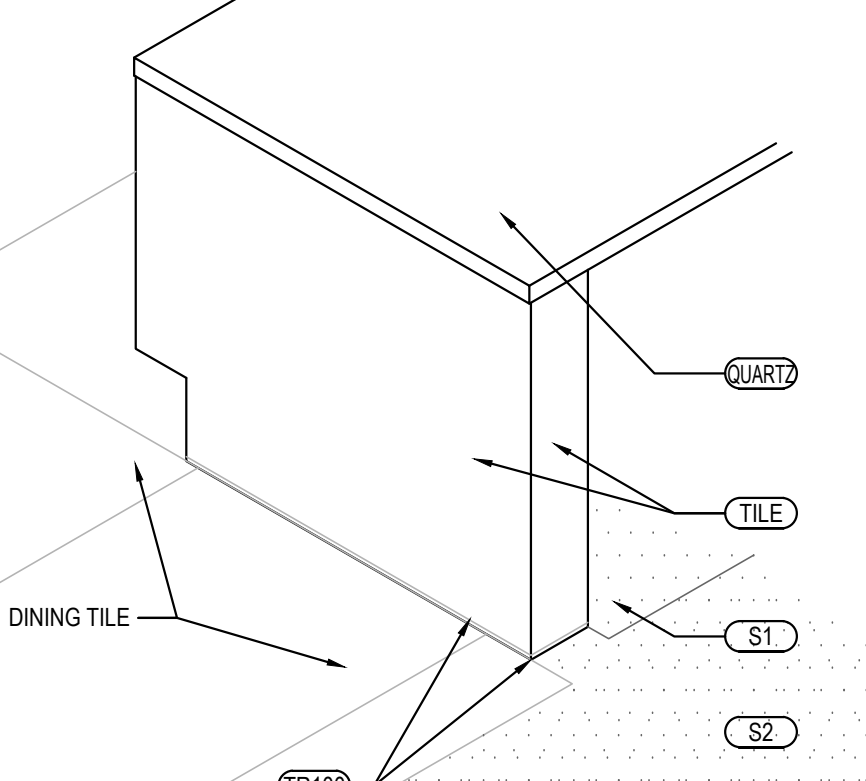

TILE SCHEDULE

INSTALLED AND FURNISHED BY: G.C. UNLESS NOTED OTHERWISE

01-11-19

| NO. | MANUFACTURER | DESCRIPTION | COLOR | FINISH | JOINT | GROUT | REMARK |
|---------|--|------------------------------------|--------------------------------|-----------------|-------------------------------|--------|--|
| (T-108) | CMC AGGREGATE DOUG SALATINO 518-713-5371 | 12" X 24" X 3/8" | - | - | 1/8" | G-111 | RESTROOM WALL |
| (T-109) | DALTILE | 6" X 36" X 3/8" 9" X 36" X 3/8" | FOREST PARK TIMBERLAND FP97 | - | 1/8" | G-113 | RR VESTIBULE & DINING ROOM WALLS CONTACT: NATIONAL ACCOUNT SUPPORT DESK 877.556.5728 (national.accounts@daltile.com) |
| (T-200) | CMC DOUG SALATINO 518-713-5371 | 24" X 24" | BRAVADA GREIGE | MATTE | 1/8" | G-96 | DINING & RESTROOM FLOOR |
| (T-300) | EMSER - ECHO | 3" HEXAGON | CALACATTA | MATTE | 1/8" | G-114 | BEVERAGE COUNTER BACKSPLASH AND SERVICE COUNTER |
| (S1) | SILIKAL | QUARTZ BLEND #4 | - | PLAIN | - | - | KITCHEN, SERVICE FLOOR CONTACT MARK FELDMAN 770-830-1404 (mfieldman@silikalamerica.com) |
| (S2) | SILIKAL | QUARTZ BLEND #4 | - | ABRASIVE | - | - | JOHN COTHMAN 888-830-1404 (cothman@silikalamerica.com) |
| GROUT | MANUFACTURER | DESCRIPTION | MFG. | COLOR | FINISH | REMARK | |
| (G-96) | MAPEI 800.42.MAPEI WWW.MAPEI.COM | LATEX MODIFIED GROUT | 11 | SAHARA BEIGE | POLY BLEND 1/8" NON-SANDED | | DINING & RESTROOM FLOOR APPLY GROUT SEALER |
| (G-111) | MAPEI 800.42.MAPEI WWW.MAPEI.COM | LATEX MODIFIED GROUT | 19 | PEARL GREY | POLY BLEND 1/8" NON-SANDED | | RESTROOM, DINING APPLY GROUT SEALER |
| (G-113) | MAPEI 800.42.MAPEI WWW.MAPEI.COM | LATEX MODIFIED GROUT | 07 | CHOCOLATE | POLY BLEND 1/8" NON-SANDED | | APPLY GROUT SEALER |
| (G-114) | MAPEI 800.42.MAPEI WWW.MAPEI.COM | LATEX MODIFIED GROUT | 19 | PEARL GREY | POLY BLEND 1/8" NON-SANDED | | BEVERAGE COUNTER BACKSPLASH APPLY GROUT SEALER |

* REFER A-200 EXTERIOR FINISH SCHEDULE FOR EXTERIOR DECORATIVE TILE

* SCHLUTER SYSTEM ALUMINUM TRIM:

COVE TILE TRIM: INSTALLED AT RESTROOM, SERVICE COUNTER, AND DRINK STATION
SCHLUTER SYSTEMS DILEX-AHK 1S 125 ATGB (BRUSHED NICKEL ANODIZED ALUMINUM)
(TR100) -OUTSIDE CORNER CONNECTOR PIECE: DILEX-AHK-E90/AHK 1S 125 ATGB (BRUSHED
NICKEL ANODIZED ALUMINUM)
-INSIDE CORNER CONNECTOR PIECE: DILEX-AHK-I90/AHK 1S 125 ATGB (BRUSHED
NICKEL ANODIZED ALUMINUM)
-END CAP PIECE: DILEX-AHK-E/AHK 1S 125 ATGB (BRUSHED NICKEL ANODIZED
ALUMINUM)
EDGE TILE TRIM:
SCHLUTER SYSTEMS RONDEC-RO125 ATGB (BRUSHED NICKEL ANODIZED ALUMINUM)
(TR101) -OUTSIDE CORNER CONNECTOR PIECE: RONDEC-EV/RO125 ATGB (BRUSHED NICKEL
ANODIZED ALUMINUM)
-INSIDE CORNER CONNECTOR PIECE: RONDEC-I2L/RO125 ATGB (BRUSHED NICKEL
ANODIZED ALUMINUM)
SCHLUTER SYSTEMS RONDEC-RO80 ATGB (BRUSHED NICKEL ANODIZED ALUMINUM)
(TR101A) -OUTSIDE CORNER CONNECTOR PIECE: RONDEC-EV/RO180 ATGB (BRUSHED NICKEL
ANODIZED ALUMINUM)
-INSIDE CORNER CONNECTOR PIECE: RONDEC-I2L/RO80 ATGB (BRUSHED NICKEL
ANODIZED ALUMINUM)
SCHLUTER SYSTEMS JOLLY-A-80 ATGB (BRUSHED NICKEL ANODIZED ALUMINUM)
(TR103) -OUTSIDE EDGE PROTECTION PIECE

* EPOXY GROUT BY MAPEI, KERAPOXY IEG, 100% SOLIDS INDUSTRIAL GRADE:
AREAS: UNDER HOOD AND 36" IN FRONT OF COOKING LINE, 3 COMPARTMENT SINK AND MOP SINK AREA
SEE MANUFACTURER'S SPECIFICATION, DETAILS AND GUIDE FOR PREPARATION,
MIXING, GROUTING AND CLEANING INSTRUCTION
NOTE: SEE INTERIOR SHEETS FOR WALL/ BASE TILE LOCATIONS AND
SPECIFICATIONS

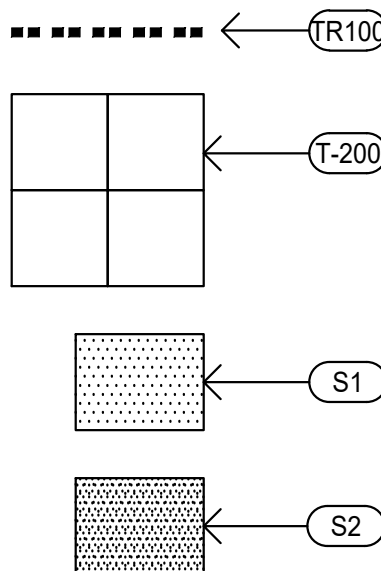

FINISH SCHEDULE

Scale= NTS

A-104

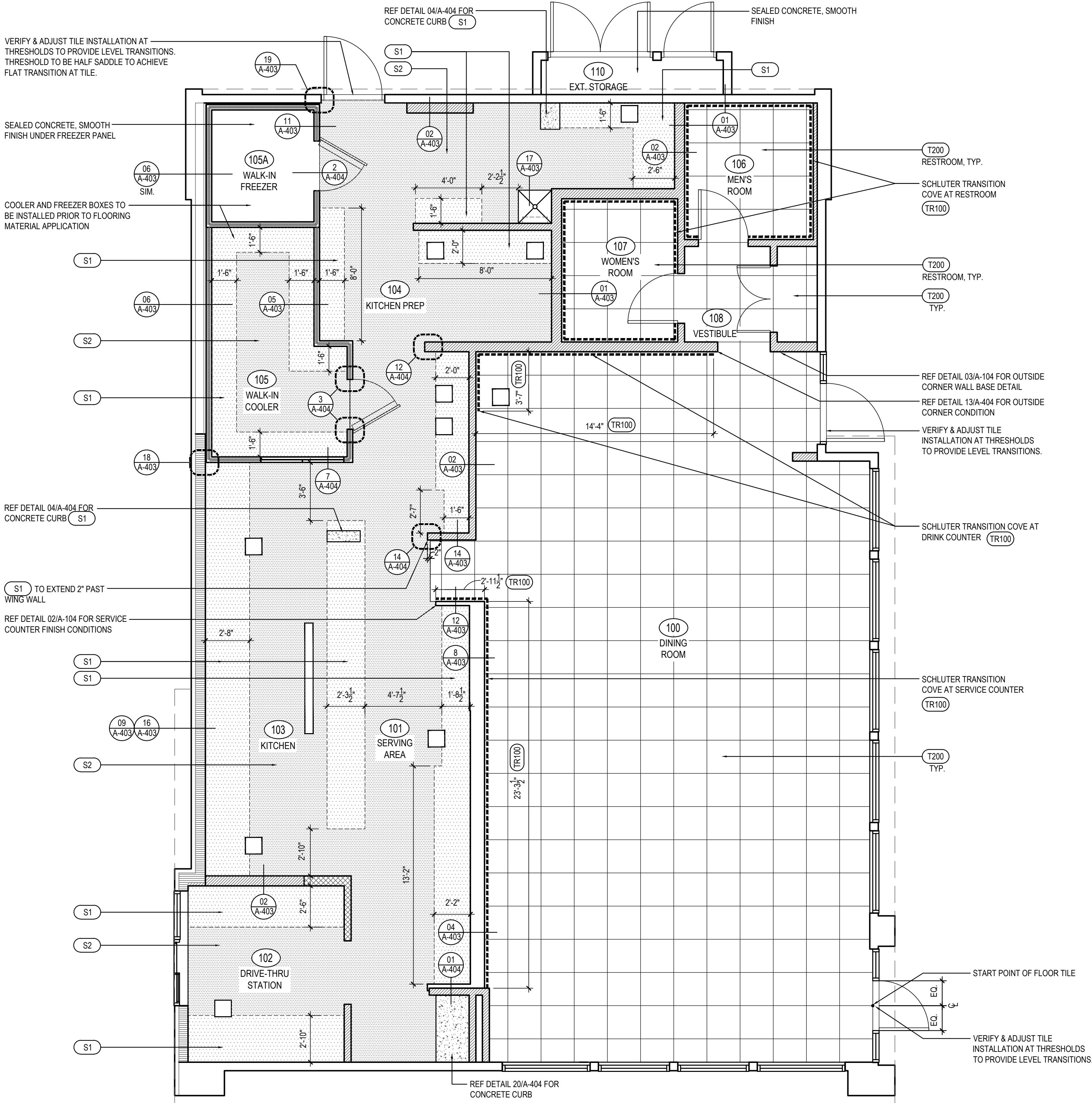

FINISH PLAN

Scale= 1/4" = 1'-0"

A-104



PANDA RESTAURANT GROUP INC.

1683 Walnut Grove Ave.
Rosemead, California
91770

Telephone: 626.799.9898
Facsimile: 626.372.8288

All ideas, designs, arrangement and plans indicated or represented by this drawing are the property of Panda Express Inc. and were created for use on this specific project. None of these ideas, designs, arrangements or plans may be used by or disclosed to any person, firm, or corporation without the written permission of Panda Express Inc.

REVISIONS:

ISSUE DATE:

1 04.29.2021 ISSUE FOR PERMIT
2 06.04.2021 ISSUE FOR BID

DRAWN BY: JDV

PANDA PROJECT #: - S8-22-D8135

C&P PROJECT #: - 2200775



06.04.2021

PANDA EXPRESS

TRUE WARM AND WELCOME 2300
SKYBROOKE BOULEVARD & STATE ROAD 54
LUTZ, FL 33558

A-104

FINISH PLAN AND SCHEDULE

TRUE WARM & WELCOME 2300 R4