

TRACT NO. 1823  
BOWERS PARK  
UNIT NO. 2

(CONSISTING OF TWO SHEETS)  
BEING A PORTION OF SECTION 33, T.6S., R.1W.,  
LYING WITHIN THE CITY OF SANTA CLARA,  
CALIFORNIA

M.D.B. & M.

SCALE: 1" = 100'

MCCRAY & SOMPS  
CIVIL ENGINEERS 1003 W. EL CAMINO REAL, SAN JOSE

AUGUST, 1957

**BASE OF BEARINGS**  
The bearing "N. 22° 35' W." of the East boundary of Tract No. 1823 Bowers Park, recorded in Book 53 of Maps at page 30 & 31 in the office of the Recorder for Santa Clara County, California, was taken as the basis of bearings shown on this map.

**NOTES:**

All distances and dimensions are given in feet and decimals thereof. The blue border line indicates the boundary of land subdivided by this map.

**LEGEND:**  
P.U.E. = Public Utility Easement.  
A.E. = Anchor Easement.  
W.O.E. = Wire Overhang Easement.  
B.S.L. = Building Setback Line.

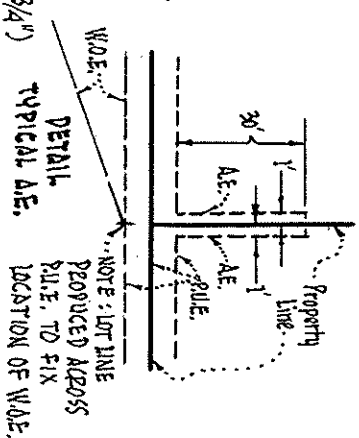

- indicates Iron Pipe set (3/4")
- indicates Iron Pipe found.
- indicates City of Santa Clara Standard Monument set.
- indicates City of Santa Clara Standard Monument found.

